

# User's Information Manual

## Air Handlers --- Vertical, Horizontal and Convertible

---

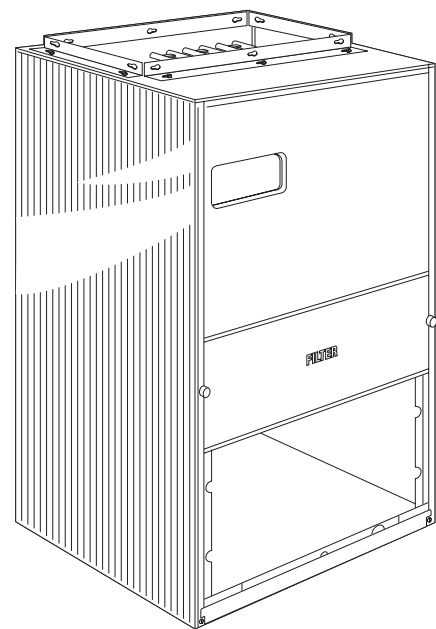
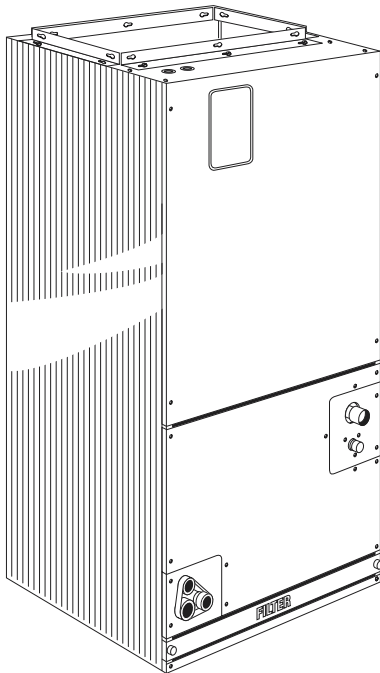
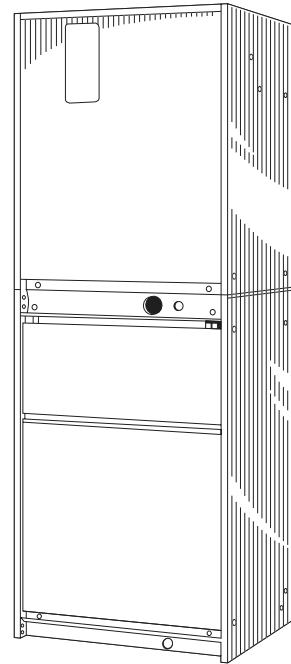
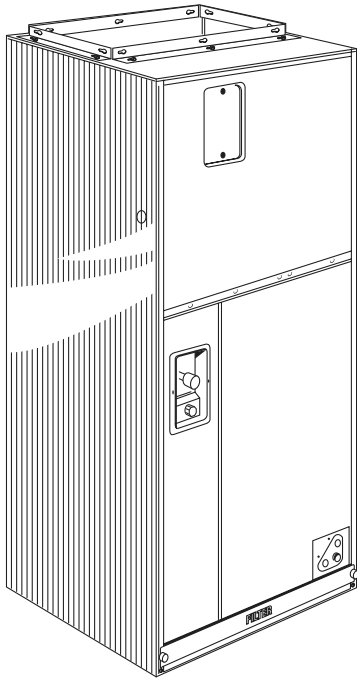

Not all models or configurations shown

# Warranty Information

## Limited Warranty

### Air Handler

4TE, 2TF, TWE-C/D/P/E, TWG, TVF

(Parts Only)

Models Less Than 6 Tons for Residential Use\*

This limited warranty is extended by American Standard Inc., to the original purchaser and to any succeeding owner of the real property to which the Air Handler is originally affixed, and applies to products purchased and re-tained for use within the U.S.A. and Canada.

If any part of your Air Handler fails because of a manufacturing defect within five years from the date of the original purchase, Warrantor will furnish without charge the required replacement part. Any local transportation, related service labor, air filters and diagnosis calls are not included.

This limited warranty does not cover failure of your air handler if it is damaged while in your possession, damage caused by unreasonable use of the air handler and/or damage from **failure to properly maintain** the air handler as set forth in the Use and Care manual (**see Proper Maintenance section**).

This limited warranty applies to product installed on or after 10/1/2001 where product is manufactured after 1/1/2000. This limited warranty is not retroactive to any installations prior to 10/1/2001 or on product produced prior to 2000.

**THE LIMITED WARRANTY AND LIABILITY SET FORTH HEREIN ARE IN LIEU OF ALL OTHER WARRANTIES AND LIABILITIES, WHETHER IN CONTRACT OR IN NEGLIGENCE, EXPRESS OR IMPLIED, IN LAW OR IN FACT, INCLUDING IMPLIED WARRANTIES OF MERCHANTABILITY AND FITNESS FOR PARTICULAR USE, AND IN NO EVENT SHALL WARRANTOR BE LIABLE FOR ANY INCIDENTAL OR CONSEQUENTIAL DAMAGES.**

Some states do not allow limitations on how long an implied limited warranty lasts or do not allow the exclusion or limitation of incidental or consequential damages, so the above limitation or exclusion may not apply to you. This limited warranty gives you specific legal rights, and you may also have other rights which vary from state to state.

Parts will be provided by our factory organization through an authorized service organization in your area listed in the yellow pages. If you wish further help or information concerning this limited warranty, contact:

American Standard Inc.  
Troup Highway  
Tyler, TX 75711-9010  
Attention: Manager, After Sales Support GW-627-1802

\* This limited warranty is for residential usage of this equipment and not applicable when this equipment is used for a commercial application. A commercial use is any application where the end purchaser uses the product for other than personal, family or household purposes.

## Optional Extended Warranty

Optional Extended Warranties are available from the Manufacturer. The Extended Warranty can be purchased from your dealer and is in effect when you have received an Extended Warranty Certificate. **No additional warranty, either written or implied, is extended by the Manufacturer without an Extended Warranty Certificate from the Manufacturer.** If you do not receive your Extended Warranty Certificate within 45 days of purchase, please call 800-554-6413.

### Reduce the burden of unexpected repair bills with an Extended Warranty.

American Standard Inc. offers the finest quality products and manufacturer's warranties on the market. But, like all good things, the Manufacturer-provided limited warranty on your new comfort equipment will come to an end. To keep you protected, American Standard Inc. offers the Extended Warranty Program. It picks up right where your Manufacturer's limited warranty leaves off. And, it offers years and years of reliable protection at a low cost. Ask your dealer for program details. The American Standard Inc. Extended Warranty provides:

1. The opportunity to supplement your Limited Warranty for five or ten years.
2. Coverage that may include parts only or parts and labor for the duration of the agreement. Be certain you read the Extended Warranty for complete details and exclusions.
3. Service work performed by servicers knowledgeable of the operation of your equipment.

### CAUTION

To prevent injury, death, or property damage, read and follow all instructions and warnings, including labels shipped with or attached to unit before operating your new air conditioning system.

### Contents

Warranty Information.....	2
Proper Maintenance.....	3
The Problem Solver.....	4

# Proper Maintenance reduces electricity use.

## ⚠ WARNING

Improper installation, adjustment, alteration, service, maintenance, or use can cause explosion, fire, electrical shock, or other conditions which may cause personal injury or property damage. Consult a qualified installer or service agency for information or assistance. The qualified installer or agency must use factory-authorized kits or accessories when modifying this product.

## ⚠ WARNING

Disconnect all electrical power to the indoor air handler or furnace before removing access panels to perform any maintenance. Disconnect power to both the indoor and outdoor units. NOTE: There may be more than one electrical disconnect switch. Electric shock can cause personal injury or death.

### A clean filter saves money.

Help ensure top efficiency by cleaning the filter regularly. When the unit circulates and filters the air in your home, dust and dirt particles collect on the filter located in your indoor unit. Excessive buildup forces the system to run longer to maintain your set temperature. And you end up paying for it.

**Clean or replace your filter at least once a month** or twice a month when the system is running more.

## ⚠ CAUTION

Although special care has been taken to minimize sharp edges in the construction of your unit, be extremely careful when handling parts or reaching into the unit.

If you have a semi-permanent filter, you can take the filter out of the frame and vacuum it. Where disposable filters are used, they

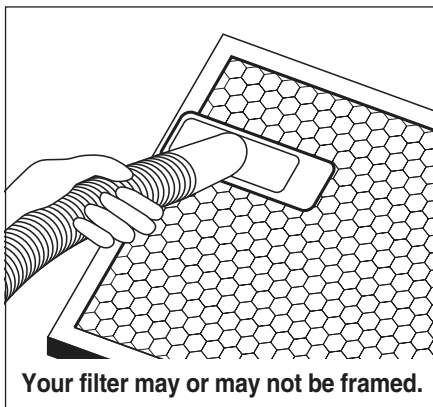

must be replaced every month with the same size as originally supplied. Both methods are quick and easy and guaranteed to cut the energy used by your system. When replacing your air handler filters,

always use the same size and type that was originally supplied. Filters are available from your dealer.

### How to remove your filter.

Ask your dealer where the filter is located when your system is installed. It may be behind the bottom panel of your indoor unit. Or it may be at the top, bottom, or either side. Or there may be two filters.

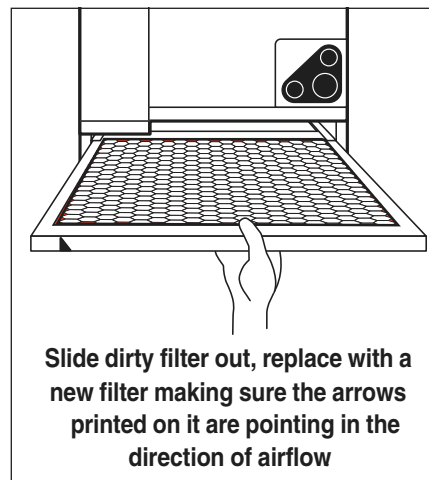
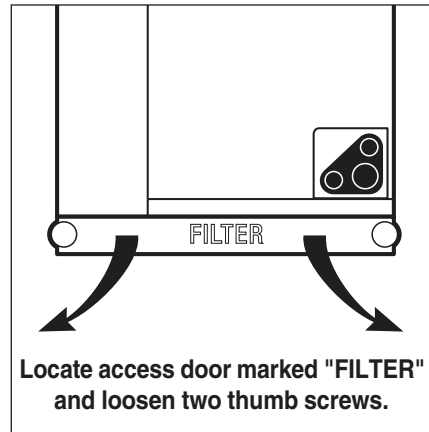

In any case, removing a filter is easy. Just make sure you insert the clean filter with the arrows on it pointing in the direction of the airflow. Your installing dealer is your best source of filter and maintenance information.

### Cut operating costs by keeping snow, ice and debris clear of your outdoor heat pump unit.

Efficient operation of your outdoor unit requires the free flow of air over the coils. Anything that blocks this flow forces the unit to work harder to do its job. At no time should anything be stacked against the side of the outdoor unit or draped over it. Keeping it clear of debris helps it work at peak efficiency, and that helps hold down operating costs.

### Don't waste money heating and cooling when you don't need to.

## ⚠ CAUTION

If heating system is not operational during the cold weather months, provisions must be taken to prevent freeze-up of all water pipes and water receptacles. This is very important during times of vacancy.

When you're going to be away from home for a few days – or when outdoor temperatures are moderate – don't let your system run unnecessarily. Lower the thermostat to 55°F in the winter. And raise it to 85°F in summer. Then when you return – or when temperatures dictate – you can reset the system and it will immediately begin making your home comfortable again.

## ⚠ CAUTION

Condensate drains should be checked and cleaned periodically to assure condensate can drain freely from coil to drain. If condensate cannot drain freely, water damage could occur.

### Never stop the system by shutting off the main power.

If the main power is ever disconnected for more than three hours, turn off the thermostat. Then wait for at least three more hours after the power has been restored before turning the thermostat back on. Failure to follow this procedure could result in damage to your system.

**CAUTION: Whenever your house is to be vacant, arrange to have someone inspect your house for proper temperature. This is very important in below freezing weather. If for any reason your unit should fail to operate, damage could result, such as frozen water pipes.**

# The Problem Solver

Before you call for service, check the following:

Insufficient heating or cooling	<ul style="list-style-type: none"> <li>a. Dirty filters</li> <li>b. Air not circulating freely</li> <li>c. Blocked outdoor coil</li> </ul>	<ul style="list-style-type: none"> <li>a. Clean or replace</li> <li>b. Check supply registers and return grills for blockage</li> <li>c. Clear away leaves or other debris</li> </ul>
Failure to operate	<ul style="list-style-type: none"> <li>a. Power off</li> <li>b. Open circuit breaker or burned-out fuses</li> <li>c. Improperly adjusted thermostat</li> </ul>	<ul style="list-style-type: none"> <li>a. Make sure switch is in the ON position</li> <li>b. Reset circuit breaker, or replace burned-out fuses</li> <li>c. Check setting, adjust thermostat</li> </ul>
Unusual Noise		Call your local Servicer

This unit is not a household appliance. It is a complex self-contained system that requires professional maintenance and repair. That's why attempts at do it yourself repairs on an in-warranty unit may void the remainder of your warranty. Other than performing the simple maintenance recommended in this manual, you should not attempt to make any adjustments to your system.

**NOTE:** The blower motor bearings are factory lubricated and under normal operating conditions usually do not require servicing. Your local servicer can advise you if oiling is required. Your dealer should be able to take care of any questions or problems you may have.

**Keep your unit looking like new for years.**

Clean the enamel finish of your unit with ordinary soap and water. For stubborn grease spots, use a household detergent. Lacquer thinner or other synthetic solvents may damage the finish.

**Just set the temperature you want.**

Set temperatures by using the indicators on the thermostat\* control. After that, your comfort control center (thermostat) will maintain a constant indoor temperature, regardless of changes in outdoor temperatures. Read your thermostat manual for directions on setting the temperatures.

**Save energy with an electronic programmable thermostat.**

With an electronic programmable

thermostat\* energy savings is easy. Just program the thermostat for the temperatures you are most comfortable with and it will automatically change settings up to four times a day. Special weekend and vacation schedules are also easily programmed for comfort and savings. Read your thermostat manual for programming instructions. If you want the optimum balance between comfort and the cost of running your system, we recommend keeping the temperature settings at 68°F for heating and 78°F for cooling.

**Save energy by letting the thermostat do its job.** Once you set the thermostat, keep subsequent adjustments to a minimum. Adjust it only when a new program is needed.

\*Optional accessory



American Standard Inc.  
6200 Troup Highway  
Tyler, Texas 75711

American Standard Inc. has a policy of continuous product and product data improvement, it reserves the right to change design and specifications without notice.